

AI for Earth Sciences Workshop – 2026

Welcome & Introduction

Welcome!

Thank you for being here.

We put this event together to create space for people working with AI in climate, energy, and earth systems to share what they're doing and work through real problems together. We'll keep things practical, with a mix of short talks and hands-on sessions.

Who We Are

EnviTrace is a New Mexico-based, woman-owned company founded in 2021, applying AI to environmental and subsurface data. We focus on making complex data more usable for real-world decisions.

Outcomes

What will you leave with today?

- A clearer sense of how AI is being used in earth sciences today
- Exposure to real workflows, tools, and datasets
- Ideas you can apply to your own work
- Connections with others working in this space

Venue Information

WiFi: No password needed. Network name: *Convention Center*

Lunch Spots in Proximity: See bottom of Event Website for list with links

Contact/Help: Find someone in an EnviTrace shirt for assistance



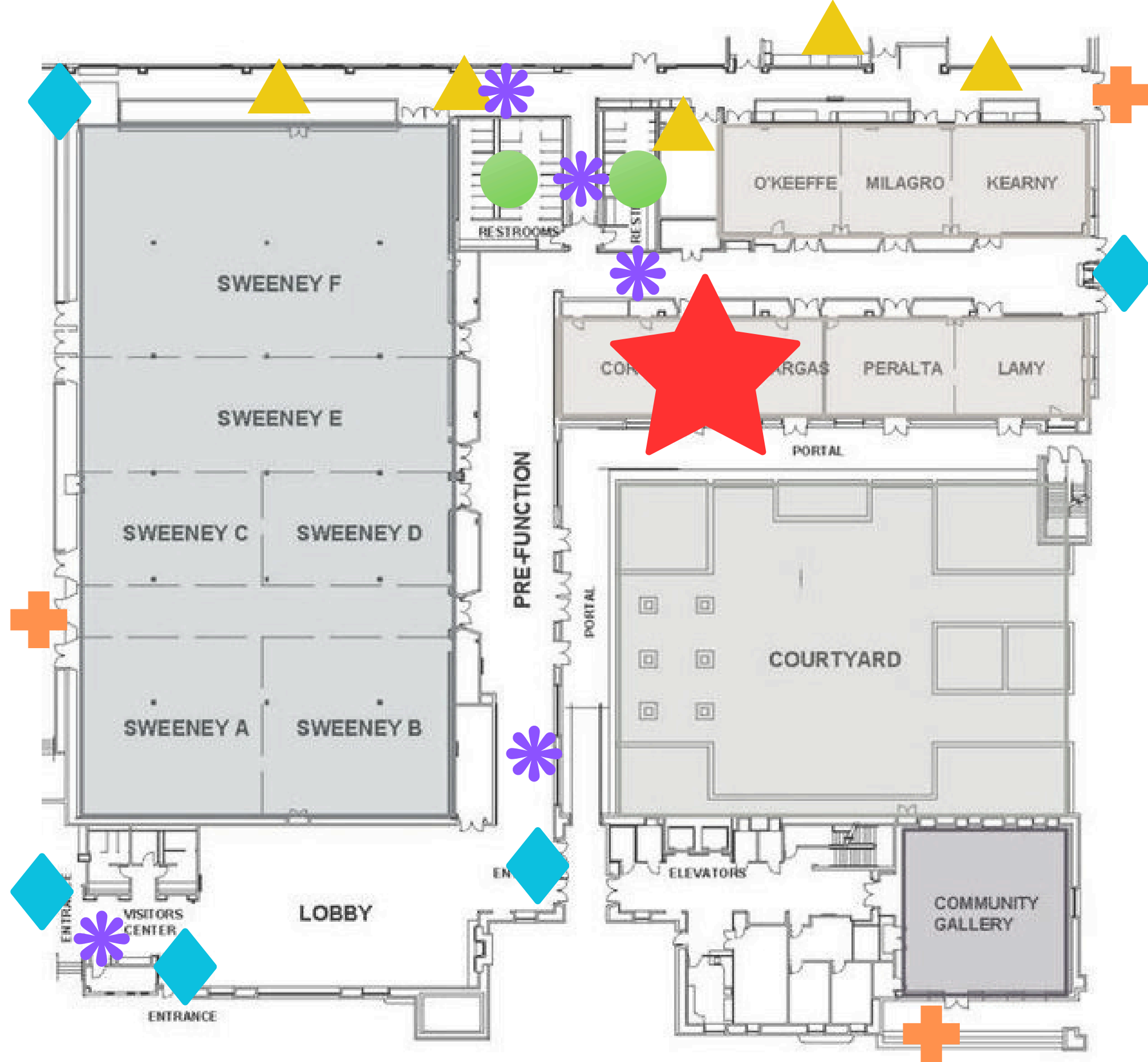

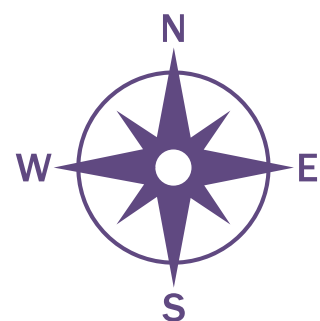

Grant Ave.



West Marcy St.



Map Legend

-  You are here!
Coronado + DeVargas Rooms
-  Fire Extinguisher
-  Restrooms
-  Primary Exit
-  Secondary Exit
-  Accessible Ramp

Safety Guidelines

- Know your nearest exit.
- Follow staff instructions.
- Exit calmly if needed, do not block doors or hallways.

Privacy, Terms & Media

- By registering, you agreed to our **privacy policy** and **media release**.
- **Photos or recordings may be taken.**
- If you prefer not to be included, please let us know.

Code of Conduct

- Be **respectful** and **professional**.
- **Share** space and time with others.
- No **harassment** or **discrimination**.
- **Concerns?** Talk to an organizer.

Schedule of Events

Day 1 – Morning

Track your personal agenda in the event's mobile app.

9:00 - 9:15

**Introduction & Welcoming Notes:
The Future of AI-Enabled Earth Insights**
Tris Kliphuis & Monty Vesselinov

9:15 - 10:00

**EnviTrace team presents:
Intro to AI for Earth Sciences: A Primer**

10:00 - 10:30

**Earthquake Dynamics from Graph
Neural Networks**
Dunyu Liu

10:30 - 11:00

Using AI/ML to Understand Arctic Snow
Katrina Bennett

11:00 - 11:30

Break & Mingle

11:30 - 12:15

**AI Foundation Models for Complex
Tectonic Applications**
Christopher Johnson

12:15 - 1:45

Lunch Break

Schedule of Events

Day 1 - Afternoon

Track your personal agenda in the event's mobile app.

1:45 - 2:30

**The Transparent Earth:
A Multimodal Foundation Model for the
Earth's Subsurface**
Daniel O'Malley

2:30 - 3:00

**The What World: A Geoscientist's
Guide to Building with GenAI**
Nate Suurmeyer

3:00 - 3:15

Break & Mingle

3:15 - 3:30

**Solving Probabilistic Inverse Problems
with Generative AI**
Adam Rupe

3:30 - 3:45

**Anatomy of a Seismic Time Series:
Information, Prediction, and Limits on
Learning**
Mikhael Semaan

3:45 - 4:30

**Multilayer Perceptron Model for
Predicting Conservative Solute
Transport in Streams and Rivers**
Lina Rodridguez

4:30 - 5:15

Panel of Speakers/Roundtable Discussion
moderated by Monty Vesselinov

5:30 - 7:30

**Offsite Reception : Local craft beer & bites at
The Brakeroom, Santa Fe Brewing Company**

Sponsors

Thank you to the organizations that helped make this event possible.

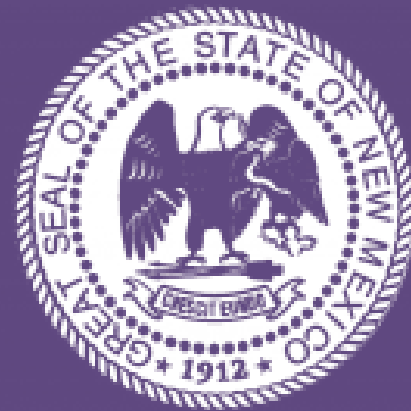

EDD

ECONOMIC
DEVELOPMENT
DEPARTMENT



CITY OF SANTA FE
ECONOMIC DEVELOPMENT

AGUA SULIS

GROOVY BEAN
JAVA JOES
COFFEE ROASTERS



Land Acknowledgement

We gather here at the Santa Fe Convention Center in O'ga P'ogeh Owingeh (White Shell Water Place) on the ancestral lands of the Tewa-speaking Pueblo peoples. This includes Santa Fe, Tesuque, Pojoaque, Nambe, Ohkay Owingeh, among others, and in proximity to the Navajo Nation.

We recognize their enduring relationship to this land and their continued presence and stewardship.

Let's
begin!